



# CLEANUP GRAPPLE

Cleanup debris quickly and easily.

## A unique design to cleanup quick!

The Rockland Cleanup Grapple allows loaders to be transformed into efficient cleanup machines. Because the clamps are equipped with powerful cylinders, grabbing and loading debris is easier than ever before. Our Cleanup Grapple is built from high-strength alloy plate.

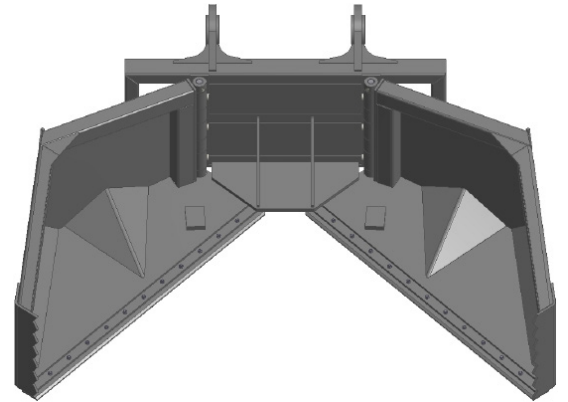
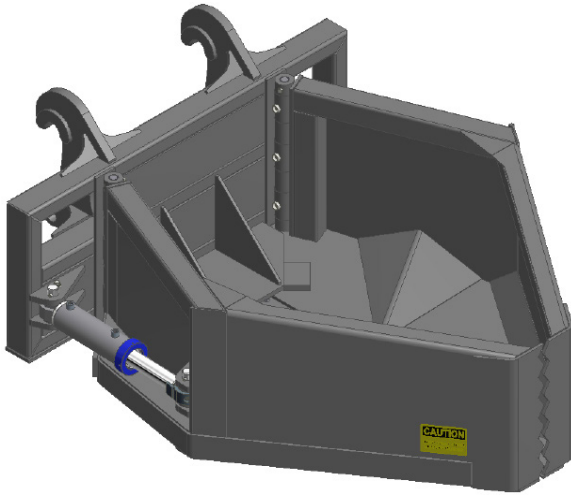

The cleanup grapple is an effective tool because the two arms wrap around a pile and surround the debris. With a standard bucket, you can spend a lot of time pushing debris around, instead of getting it loaded and getting the job done. The cleanup grapple makes it easy to pick up smaller debris without having an extra person on the ground.

## SPECIFICATIONS

Machine Category	5/10	20/30/40
Closed Width (")	66 1676	69 1753
Open Width (")	96 2642	114 2895
Cylinder Size (")	3-1/2 89	4 102
Weight (lbs.)	1550 703	2750 1247

mm/kg

Specifications subject to change without notice.

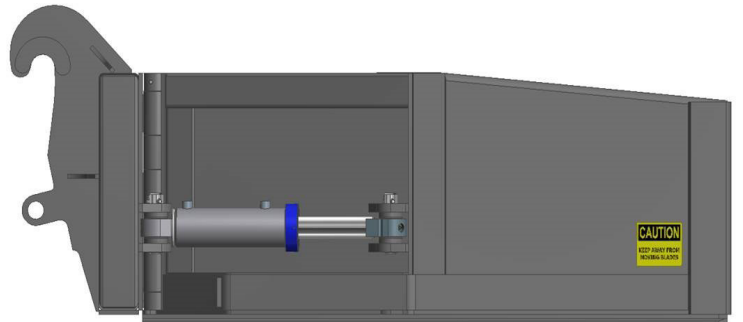

## INSTALLATION INFORMATION

Cleanup Grapples mount in place of the standard bucket using factory pins or coupler brackets. The loader must be equipped with a three-spool valve and boom arm piping. Cleanup Grapples come with jumper hoses.

### WARRANTY

Rockland Cleanup Grapples are guaranteed against failure due to defective design, materials or workmanship for a period of two years or 4000 hours.



Distributed by:

**ROCKLAND MANUFACTURING CO.**  
P O BOX 5  
800-458-3773  
BEDFORD, PA 15522  
www.rocklandmfg.com