

# SPECIFICATIONS

## Stick Mounted Hydraulic Thumbs

### BTH

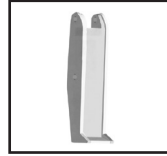

EXCAVATOR CLASS		E20	E30	E35, E40	E50	E70	
EXCAVATOR WEIGHT		15,001 lbs. to 25,000 lbs.	25,001 lbs. to 33,000 lbs.	33,001 lbs. to 52,000 lbs.	52,001 lbs. to 70,000 lbs.	70,001 lbs. to 90,000 lbs.	
BTH STANDARD	Weight (lbs)	570 259	795 356	820 372	795 336	820 372	1115 506

### BTH-W



EXCAVATOR CLASS		E30	E35	E40	E50	E70	E100
EXCAVATOR WEIGHT		25,001 lbs. to 33,000 lbs.	33,001 lbs. to 40,000 lbs.	40,001 lbs. to 52,000 lbs.	52,001 lbs. to 70,000 lbs.	70,001 lbs. to 90,000 lbs.	90,001 lbs. to 110,000 lbs.
BTH-W	Tip Radius Weight (lbs)	46" - 52" 825	46" - 52" 825	49" - 55" 925	56" - 64" 1350	60" - 68" 1710	65" - 73" 2465
	Tip Radius Weight (lbs)	52" - 58" 910	52" - 58" 910	55" - 61" 975	64" - 72" 1400	68" - 76" 1770	73" - 81" 2520
	Tip Radius Weight (lbs)	58" - 64" 990	58" - 64" 990	61" - 67" 1100	72" - 80" 1450	76" - 84" 1830	81" - 89" 2575
	Tip Radius Weight (lbs)			67" - 73" 1200			

## Stick Mounted Solid Strut Thumbs

### BTS

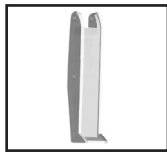

EXCAVATOR CLASS		E20	E30	E35, E40	E50	E70	
EXCAVATOR WEIGHT		15,001 lbs. to 25,000 lbs.	25,001 lbs. to 33,000 lbs.	33,001 lbs. to 52,000 lbs.	52,001 lbs. to 70,000 lbs.	70,001 lbs. to 90,000 lbs.	
BTS STANDARD	Weight (lbs)	390 177	665 302	900 408	940 426	960 435	1110 503

### BTS-W

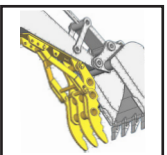

EXCAVATOR WEIGHT		25,001 lbs. to 33,000 lbs.	33,001 lbs. to 52,000 lbs.	52,001 lbs. to 70,000 lbs.	70,001 lbs. to 90,000 lbs.	90,001 lbs. to 110,000 lbs.
MODEL		ETU30	ETU40	ETU50	ETU70	ETU100
BTS-W STANDARD	Weight (lbs)	750 340	1150 522	1500 680	1920 871	2300 1043
MODEL		-	ETU40LT	ETU50LT	-	-
BTS-W COUPLER	Weight (lbs)	-	1250 3567	1650 748	-	-

## INSTALLATION INFORMATION

All thumbs are supplied with mounting pins, hydraulic cylinder or strut, and a mounting plate that must be welded to the bottom of the stick. Hydraulic thumbs require a control valve and hydraulic plumbing that includes a relief valve in the thumb circuit that provides relief when the control valve is in all three positions.

### WARRANTY

Rockland Stick Mounted Thumbs are guaranteed against failure due to defective design, materials, or workmanship for a period of two years or 4,000 hours.



Distributed by:

**ROCKLAND MANUFACTURING CO.**  
P O BOX 5 BEDFORD, PA 15522  
800-458-3773 www.rocklandmfg.com

BT0419



ROCKLAND

# THUMBS

HYDRAULIC & MECHANICAL  
WIDE OR NARROW

# DO MORE WITH YOUR EXCAVATOR...

## ALL IT TAKES...



# IS THE RIGHT BUCKET THUMB.

# A THUMB FOR EVERY APPLICATION

ONE OF THESE THUMBS IS RIGHT FOR YOU

## BTH Stick Mounted Hydraulic Thumb



BT-H Hydraulic Thumbs have been the thumb of choice for thousands of contractors. They deliver more value than any other thumb. The positive three-point grip is just like picking up something with your thumb and first two fingers. The narrow design keeps thumb weight to a minimum for greater lift capacity.

### SEVERAL BTH FEATURES:

- Instant deployment, storage.
- Narrow design provides fast, positive, three-point grip on loads of all sizes.
- When retracted, the narrow profile is a big plus for close work.
- Narrow profile means less thumb weight and more load capacity.
- Cylinder rod protection eliminates rod damage.
- Lower cost than most other hydraulic thumbs.
- Patented Thumb Lock eliminates down drift. The thumb locks under the stick and is automatically released when needed.

## BTH-W Stick Mounted Wide Hydraulic Thumb



Some applications such as raking or combing small debris into the bucket require a wide thumb. Rockland BTH-W Stick Mounted Wide Hydraulic Thumbs have the same quality features as BTH Stick Mounted Hydraulic Thumbs, plus a rugged, anti-torque design that guarantees years of dependable, trouble-free service. If your application calls for a wide thumb, remember ONLY Rockland wide thumbs have a thumb lock and a cylinder rod guard.

**Wide or narrow, you simply can't do better than a Rockland Stick Mounted Hydraulic Thumb!**

## BTS Stick Mounted Solid Strut Thumb



BTS Stick Mounted Solid Strut Thumbs are the simple low-cost solution to excavator productivity. BTS Thumbs are ideal for contractors who have an excavator without stick plumbing, or only use a thumb occasionally. If you're looking for the best solid strut thumb to get the job done right -- you've found it!

### SEVERAL BTS FEATURES:

- Economical. BTS Stick Mounted Solid Strut Thumbs eliminate the high cost of stick plumbing and valves.
- Narrow design guarantees a fast, positive, three-point grip on loads of all sizes.
- When retracted, the narrow profile is a big plus for close work.
- Narrow profile means less thumb weight and more load capacity.
- Easy installation. Comes complete, already installed on the mounting plate.

## BTS-W Stick Mounted Wide Solid Strut Thumb



Here is the wide solid strut thumb that you can depend on. The BTS-W has the same features as the BTS Stick Mounted Solid Strut Thumb and is head and shoulders above other wide solid strut thumbs. There isn't a better wide solid strut thumb available. Put a Rockland BTS-W on your excavator for years of dependable service.

### BENEFITS OF A ROCKLAND THUMB...

- Every pivot pin is lubricated and sealed
- Every pivot pin is heat-treated
- All pivot points are line bored after welding for perfect alignment
- All thumbs come fully assembled for hassle-free installation
- High-strength, weight-saving alloy steel construction